

# FOX - REQUEST FORM FOR NON STANDARD LIMIT SWITCH

4

## Instructions

(See next page for list of components and legends)

- 1 Version:** tick the required version.
- 2 SIL 1 certified:** tick the box if you require SIL 1 certified units.
- 3 Revolution ratio:** write the required revolution ratio.
- 4 Standard cam set:** write the code of the cam set required.
- 5 Customized cam set:** for non standard cam sets, fill in the scheme choosing the cams and the switches required. It is possible to assemble sets with 2, 3, 4 or 5 cams/switches.  
Customized cams are available on request.
- 6 Potentiometer. encoder. Yankee:** write the code of the potentiometer, encoder or Yankee required.  
ATTENTION: it is possible to mount a potentiometer or an encoder alone or together with a set of 2 or 3 cams/switches. Potentiometers PA020001 and PA020002 can be mounted only with sets of 2 cams/switches.  
ATTENTION: Yankee may be mouted alone or together with a set of max. 4 cams/switches.
- 7 Cable clamp:** tick the cable clamp required.
- 8 Coupling. flange. pinion gear:** tick the box when coupling, flange or pinion gear are required.  
When a standard pinion gear is required, write the code number listed in the pinion gear charts in the catalogue.  
When a special pinion gear is required, write the number of teeth, the module and the primitive diameter.
- 9 Shaft:** tick the shaft type required.  
Customized shafts are available on request.
- 10 Cover holding wire:** tick when the cover holding wire is required.

### Version **1**

- Version **CE EAC**
- Version **cULus CE EAC**
- Version with anti-moisture plug **CE EAC**

ATTENTION: Rotary limit switches with shaft made of stainless steel AISI 430F are not cULus certified.

### SIL1 certified **2**

### Revolution ratio **3**

- |                                |   |
|--------------------------------|---|
| <input type="checkbox"/> 1:15  | <input type="checkbox"/> 1:150  |
| <input type="checkbox"/> 1:20  | <input type="checkbox"/> 1:200  |
| <input type="checkbox"/> 1:25  | <input type="checkbox"/> 1:250  |
| <input type="checkbox"/> 1:50  | <input type="checkbox"/> 1:300  |
| <input type="checkbox"/> 1:75  | <input type="checkbox"/> 1:450  |
| <input type="checkbox"/> 1:100 | <input type="checkbox"/> 1: <input style="width: 50px;" type="text"/> |

### Standard cam set **4**

Cam set code \_\_\_\_\_

### Customized cam set **5**

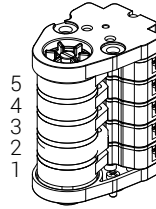

Cam code	Switch code
5 _____	_____
4 _____	_____
3 _____	_____
2 _____	_____
1 _____	_____

### Potentiometer. encoder. Yankee **6**

Code \_\_\_\_\_

### Cable clamp **7**

- M20                       M20+M16
- M20+M20

- Male coupling**                       **Coupling** **8**
- Female coupling**                       **Flange**
- Pinion gear**

Pinion gear code \_\_\_\_\_

Customized pinion gear  
No. of teeth \_\_\_\_\_  
Module \_\_\_\_\_  
Primitive diameter \_\_\_\_\_

### Standard shaft **9**

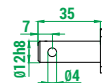

- Shaft made of stainless steel AISI 430F
- Shaft made of high resistance stainless steel AISI 303

### Flexible shaft

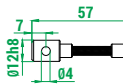

- Shaft made of stainless steel AISI 430F
- Shaft made of high resistance stainless steel AISI 303

### Cover holding wire **10**

**4 Legend - Standard cam sets**

No. and type of switches	No. and type of cams	Code
2 x PRSL0110XX	2 cams A	FCL20001
	Cams A+C	FCL20003
4 x PRSL0110XX	2 cams C	FCL20005
	Cams D+D+B+F	FCL40001
	4 cams A	FCL40003
	Cams A+A+C+C	FCL40005
	4 cams C	FCL40007
	Cams C+C+C+E	FCL40009
2 x PRSL0111XX	Cams A+A+E+E	FCL40011
	2 cams A	FCL20002
	Cams A+C	FCL20004
4 x PRSL0111XX	2 cams C	FCL20006
	Cams D+D+B+F	FCL40002
	4 cams A	FCL40004
	Cams A+A+C+C	FCL40006
	4 cams C	FCL40008
	Cams C+C+C+E	FCL40010
	Cams A+A+E+E	FCL40012

**6 Legend - Potentiometers, encoders standard and Yankee**

Description	Code
Potentiometer MCB 10 kΩ with support	PA020001
Potentiometer MCB 10 kΩ mechanical stop with support	PA020002
Potentiometer Sfernice 10 kΩ ±10% 4 pins with support	PA020003
Potentiometer Sfernice 10 kΩ ±10% 3 pins with support	PA020004
Potentiometer Sfernice 5 kΩ ±10% with support	PA020005
Encoder 36 pulses./rev. with support	PA030001
Encoder 150 pulses./rev. with support	PA030002
Yankee - current output	PA01AA01
Yankee - voltage output	PA01AB01
Yankee - PWM output	PA01AC01

**5 Legend - Switches**

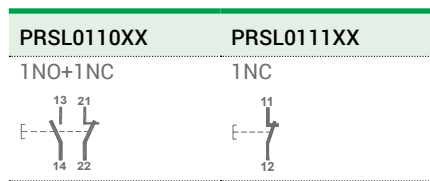

**5 Legend - Standard cams**

Cam	Code for PRSL0110XX switches	Switching angle with PRSL0110XX	Code for PRSL0111XX switches	Switching angle with PRSL0111XX	
A	1 point	PRSL7194PI	21.5° ±0.5°	PRSL7194PI	23.0° ±0.5°
B	10 points	PRSL7193PI	21.5° ±0.5°	PRSL7193PI	23.0° ±0.5°
C	60° sector	PRSL7195PI	82.0° ±0.5°	PRSL7195PI	86.0° ±0.5°
D	72° sector	PRSL7196PI	94.0° ±0.5°	PRSL7196PI	97.5° ±0.5°
E	180° sector	PRSL7191PI	204.5° ±0.5°	PRSL7191PI	203.0° ±0.5°
F	305° sector	PRSL7192PI	328.5° ±0.5°	PRSL7192PI	327.0° ±0.5°